



GENUINE PARTS

INSTALLATION INSTRUCTIONS

1. DESCRIPTION: Kayak Carrier

2. APPLICATION: Refer to Dealer Accessory Chart for Specific vehicle application.

3. PART NUMBER: 999R1 KL002

4. KIT CONTENTS:

| <u>ITEM NO.</u> | <u>QTY</u> | <u>DESCRIPTION</u> |
|-----------------|------------|--------------------|
|-----------------|------------|--------------------|

| | | |
|----|---|---------------------|
| 1) | 2 | Kayak Carrier Hoops |
|----|---|---------------------|

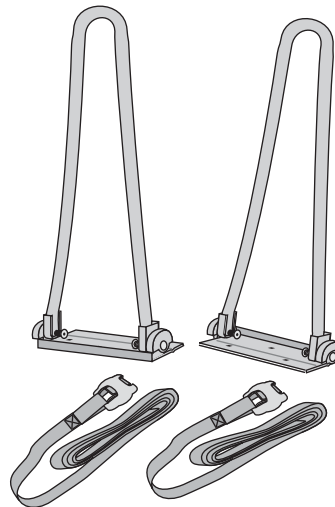

| | | |
|----|---|--------|
| 2) | 2 | Straps |
|----|---|--------|

| | | |
|----|---|--|
| 3) | 1 | Installation Instructions Replacement Template |
|----|---|--|

5. TOOLS REQUIRED:

Allen wrench (from Mighty Mount kit)

INSTALLATION INSTRUCTIONS - KAYAK CARRIER

6. INSTALLATION PRECAUTIONS / NOTES:

WARNING

- DO-NOT transport kayaks without securing bow and stern to front and rear of vehicle.
- DO NOT transport kayaks without securing TO THE CARRIER.
- DO NOT USE rope with less than 1/4" (6 mm) diameter for bow and stern line.
- SECURE kayak straps INBOARD to vehicle rack towers (see step 9b).
- DO NOT exceed kayak carrier content weight limit of 157 lbs. (71 kg.)
- DO NOT exceed your rack's weight limit:

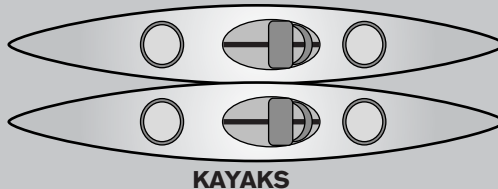

TOTAL MUST BE LESS
THAN OR EQUAL TO
RACK WEIGHT LIMIT

- ALWAYS fold rear hoop before folding front hoop (fold when not in use).

NOTES

- Crossbars must be positioned at a minimum of 30" apart.
- Retain this instruction sheet in your glove box for future reference.

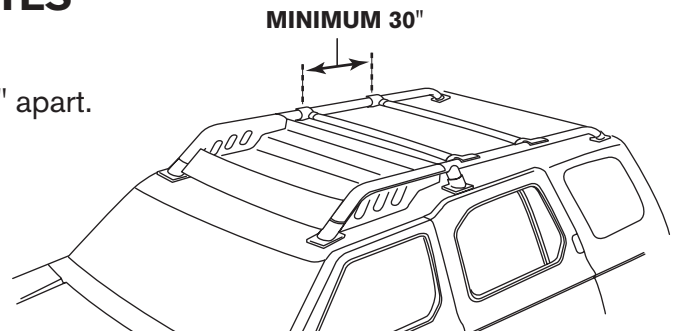

7. INSTALLATION PROCEDURE

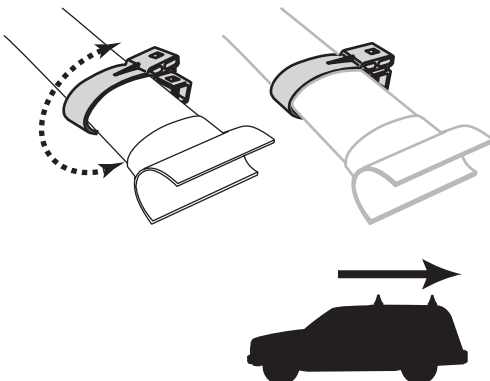

NOTE: Horizontal Mighty Mounts purchased separately.
See NISSAN-accessory application chart. Bar shape shown is for illustration purpose only.
Your cross bar may look different.

- 1) Attach 2 Mighty Mounts to each bar, opening toward REAR of car.

INSTALLATION INSTRUCTIONS - KAYAK CARRIER

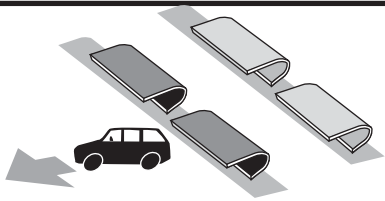

NOTE: If using horizontal Mighty Mounts with bar caps, attach **METAL** caps to front bar, **PLASTIC** caps to rear bar.

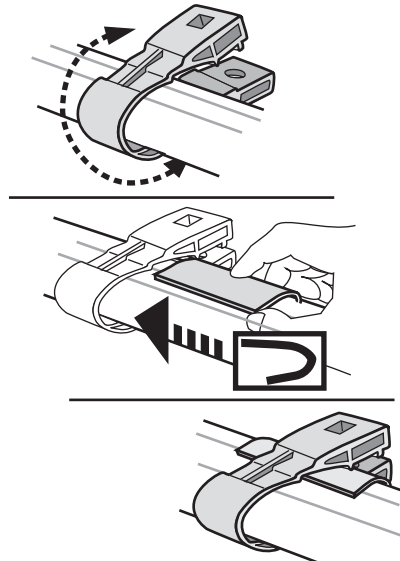

- 2) Attach bar caps (if included with Mighty Mounts), opening caps toward **FRONT** of car.

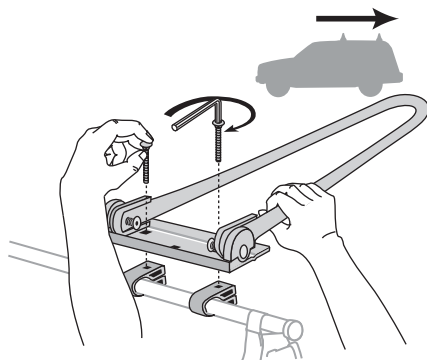

- 3) Install **FRONT** hoop folding toward **REAR** of car.

- a) Insert button head screws through base plate and into Mighty Mounts.
- b) **TIGHTEN** button-head screws with wrench (from Mighty Mount kit).

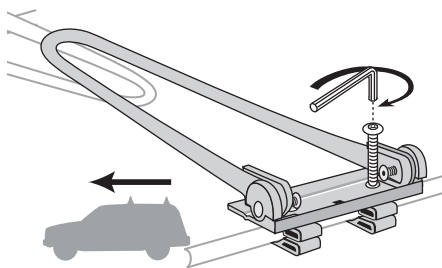

- 4) Install **REAR** hoop folding toward **FRONT** of car.

- a) Insert button head screws through base plate and into Mighty Mounts.
- b) **TIGHTEN** button-head screws with wrench (from Mighty Mount kit).

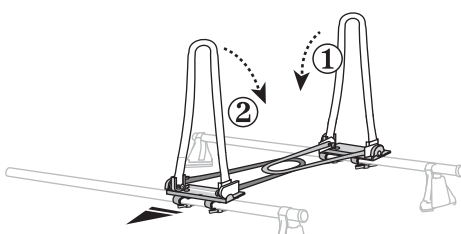

NOTE: When not in use, **ALWAYS** fold rear hoop before folding the front hoop.

INSTALLATION INSTRUCTIONS - KAYAK CARRIER

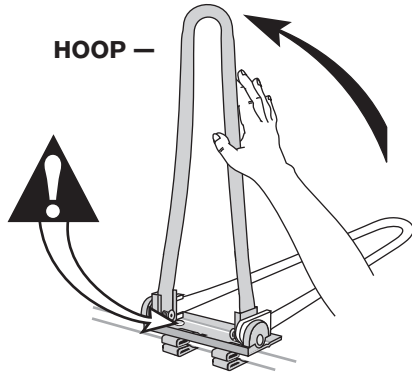

- 5) Raise kayak carrier hoop into vertical position. Check button head screws once more for security.

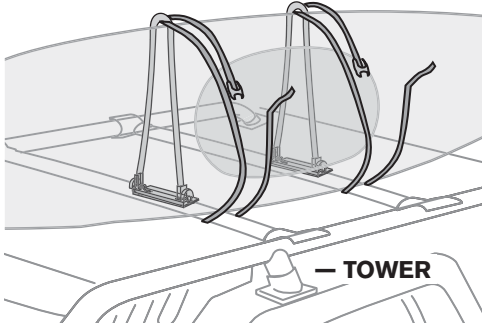

- 6) Load boat and attach straps through kayak carrier hoops, inboard to vehicle rack towers.

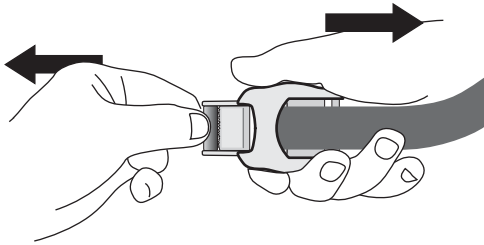

- 7) Slide rubber buckle protector off the buckle.

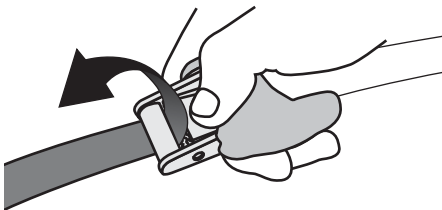

- 8) Depress tab in buckle, and insert end of plain strap into buckle as shown.

INSTALLATION INSTRUCTIONS - KAYAK CARRIER

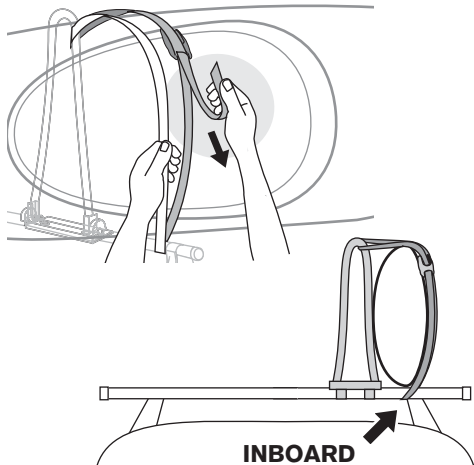

9) Tighten straps completely.

a) PULL strap end to tighten.

b) Run kayak straps INBOARD to vehicle rack towers.

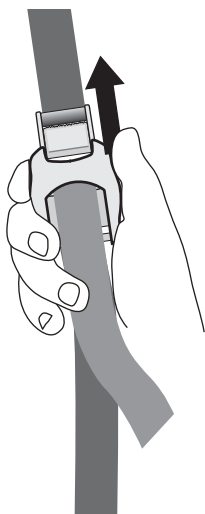

10) Replace buckle protector by sliding over buckle.

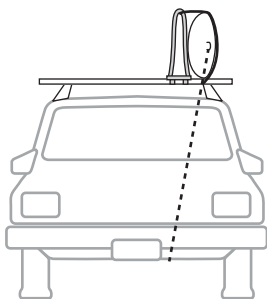

11) Tie down kayak to vehicle for safe transport.

a) Use at least 1/4" line to attach the kayak's bow and stern to the front and rear of the vehicle.

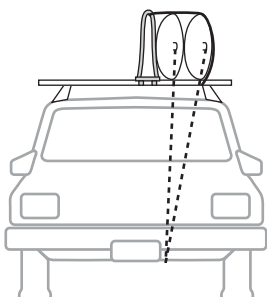

NOTE: Apply a cushion/pad to hood or bumper fascia to protect paint from scratches or scuffs from the bow line.